

STATE	PROJECT NO.	SHEET NO.	TOTAL SHEETS
N.C.	2023CPT.10.14.10131 2023CPT.10.14.20131	1	14
F.A. PROJECT NO.			

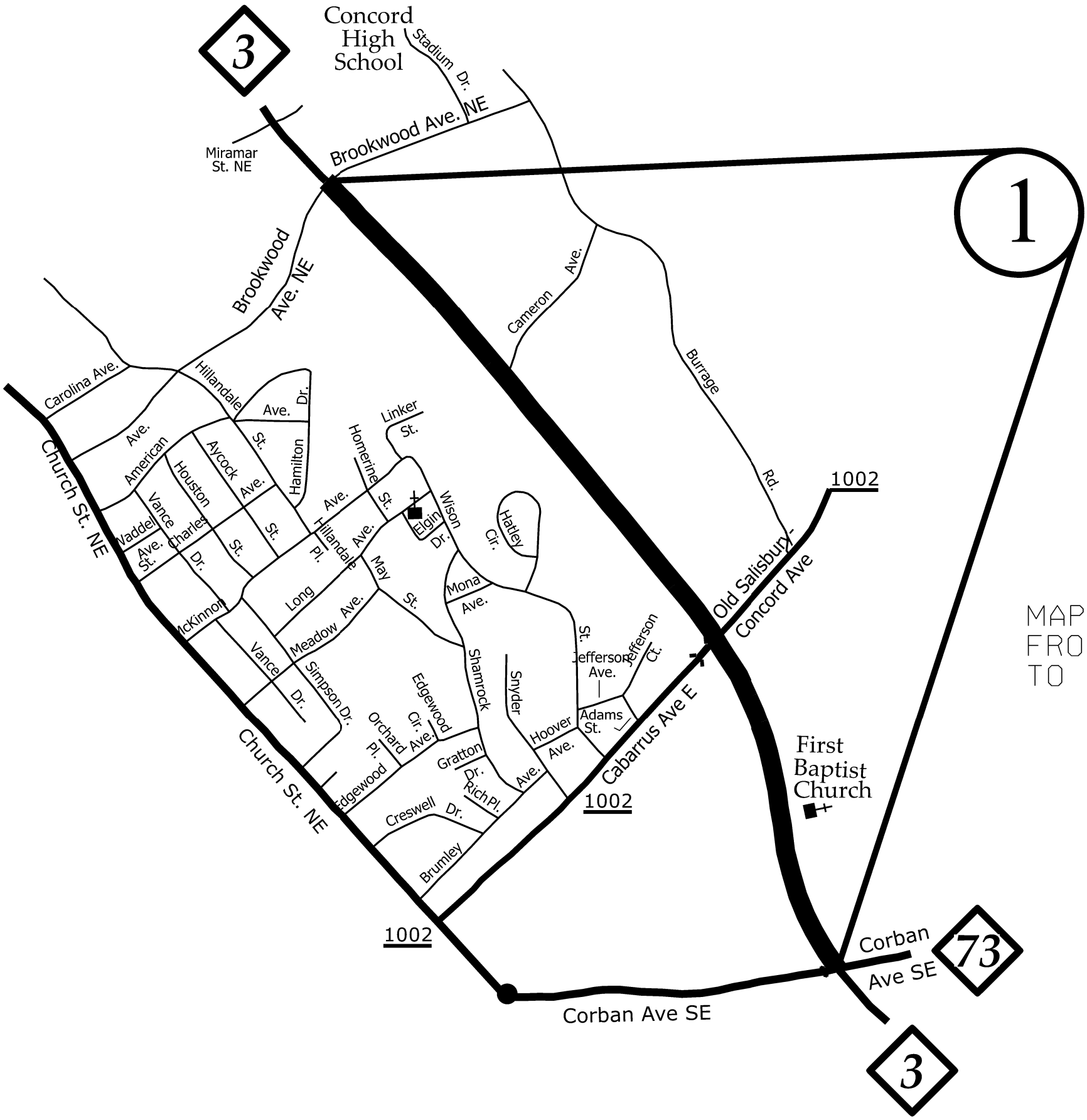

ENLARGED MUNICIPAL AND SUBURBAN AREAS  
**CABARRUS COUNTY**  
 NORTH CAROLINA  
PREPARED BY THE  
 NORTH CAROLINA DEPARTMENT OF TRANSPORTATION  
 DIVISION OF HIGHWAYS - DIVISION 10 DISTRICT 1



MAP #1 - NC 3 - BRANCHVIEW DRIVE NE 1.67 MILES  
 FROM NC 73 (CORBAN AVE. SE) (MP 2.90)  
 TO BROOKWOOD AVE NE (MP 4.57)

STATE	PROJECT NO.	SHEET NO.	TOTAL SHEETS
N.C.	2023CPT.10.14.10131 2023CPT.10.14.20131	2	14
F.A. PROJECT NO.			



ENLARGED MUNICIPAL AND SUBURBAN AREAS  
**CABARRUS COUNTY**  
 NORTH CAROLINA  
PREPARED BY THE  
 NORTH CAROLINA DEPARTMENT OF TRANSPORTATION  
 DIVISION OF HIGHWAYS - DIVISION 10 DISTRICT 1

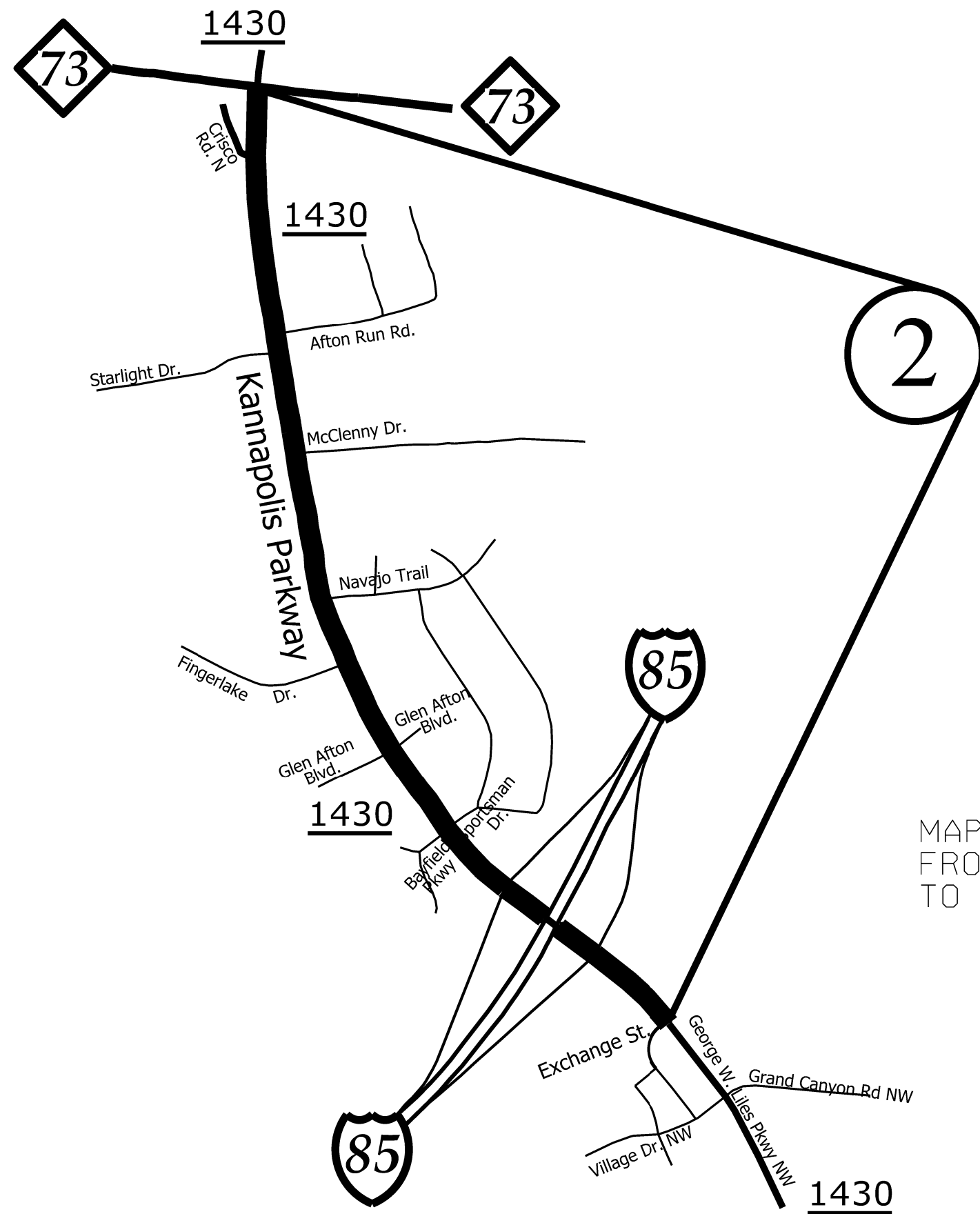

MAP #2 - SR 1430 - KANNAPOLIS PARKWAY 1.58 MILES  
 FROM NC 73 (MP 4.16)  
 TO EXCHANGE STREET (MP 5.74)

STATE	PROJECT NO.	SHEET NO.	TOTAL SHEETS
N.C.	2023CPT.10.14.10131 2023CPT.10.14.20131	3	14
F.A. PROJECT NO.			



ENLARGED MUNICIPAL AND SUBURBAN AREAS  
**CABARRUS COUNTY**  
 NORTH CAROLINA  
PREPARED BY THE  
 NORTH CAROLINA DEPARTMENT OF TRANSPORTATION  
 DIVISION OF HIGHWAYS - DIVISION 10 DISTRICT 1

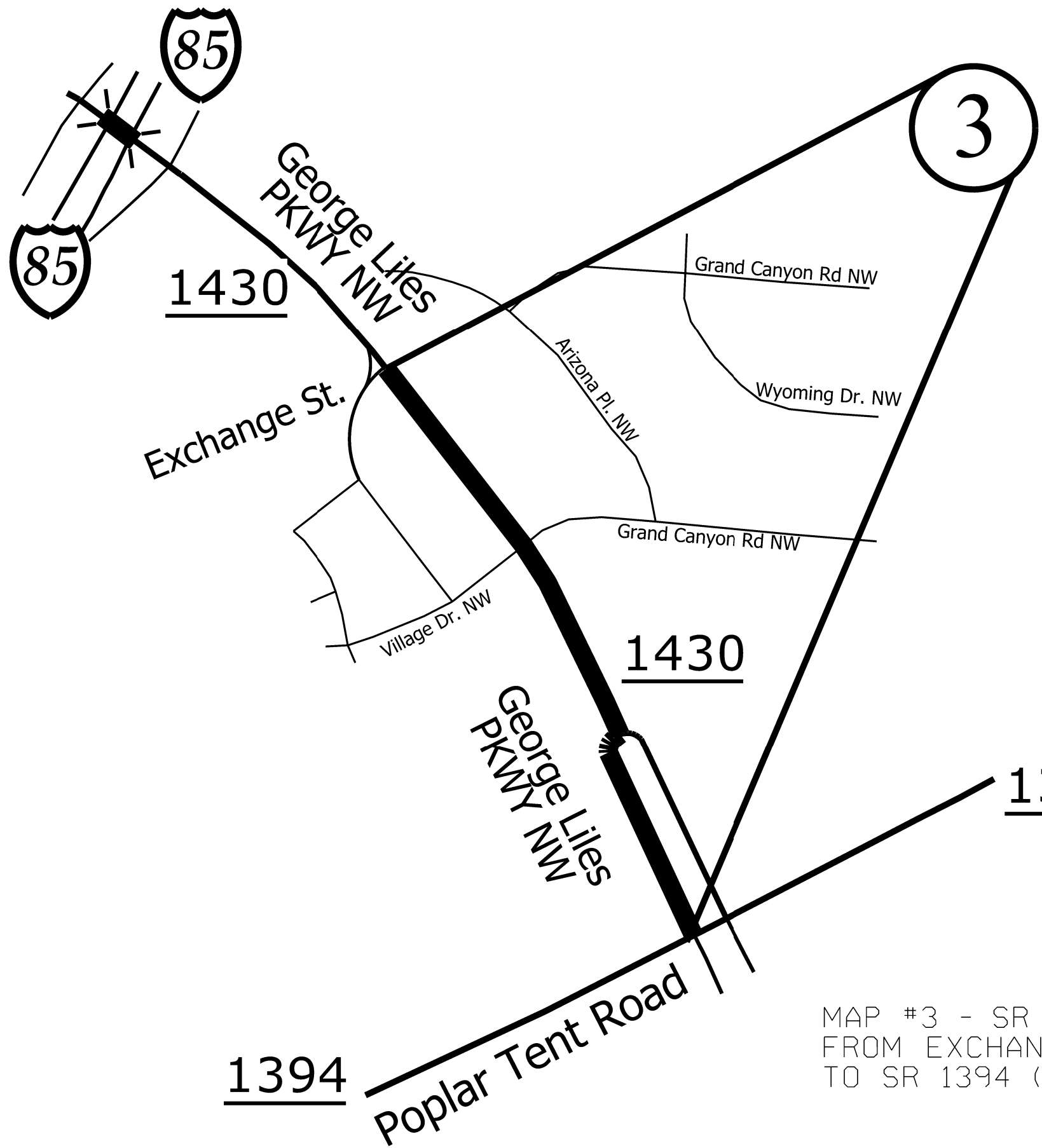

1394

Poplar Tent Road

1430

1394

MAP #3 - SR 1430 - GEORGE W. LILES PARKWAY NW 0.34 MILES  
 FROM EXCHANGE STREET (MP 5.74)  
 TO SR 1394 (POPLAR TENT ROAD) (MP 6.08)

STATE	PROJECT NO.	SHEET NO.	TOTAL SHEETS
N.C.	2023CPT.10.14.10131 2023CPT.10.14.20131	4	14
F.A. PROJECT NO.			



ENLARGED MUNICIPAL AND SUBURBAN AREAS  
**CABARRUS COUNTY**  
 NORTH CAROLINA  
PREPARED BY THE  
 NORTH CAROLINA DEPARTMENT OF TRANSPORTATION  
 DIVISION OF HIGHWAYS - DIVISION 10 DISTRICT 1

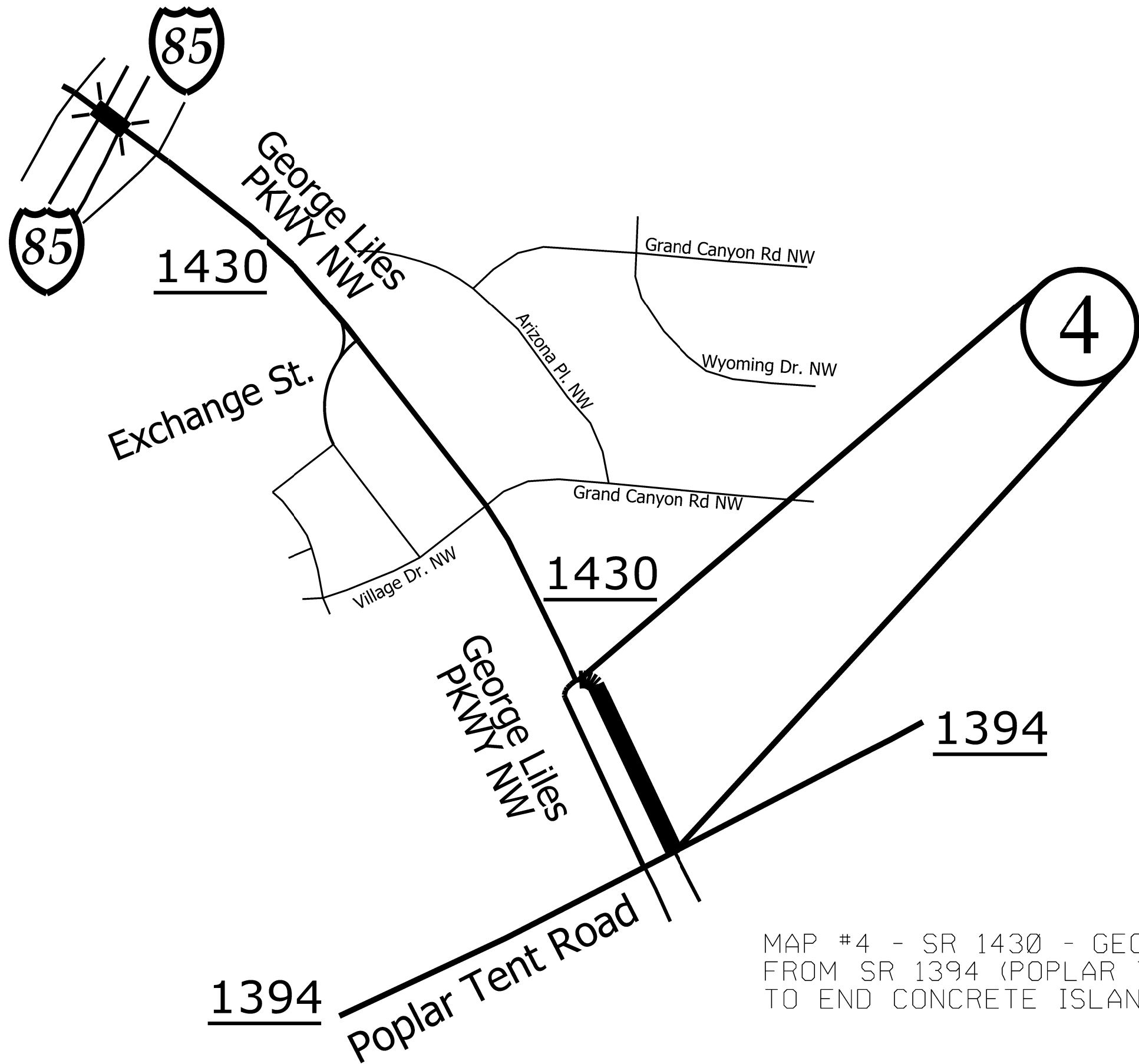

MAP #4 - SR 1430 - GEORGE W. LILES PARKWAY NW 0.12 MILES  
 FROM SR 1394 (POPLAR TENT ROAD) (MP 4.06)  
 TO END CONCRETE ISLAND (MP 4.18)

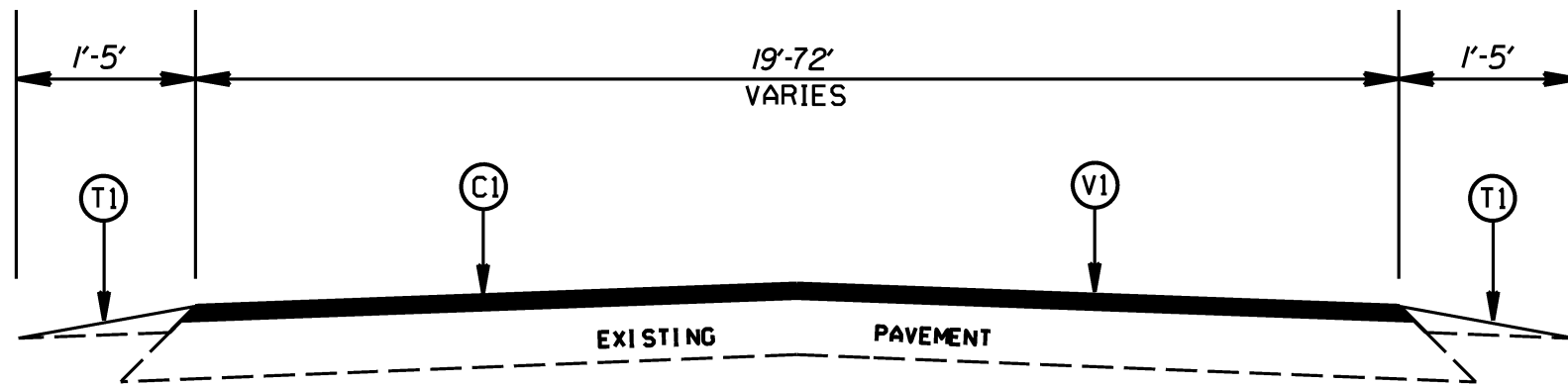

TYPICAL SECTION NO. 1

MAP 1 - NC 3 (BRANCHVIEW DRIVE NE)  
 MAP 2 - SR 1430 (KANNAPOLIS PARKWAY)

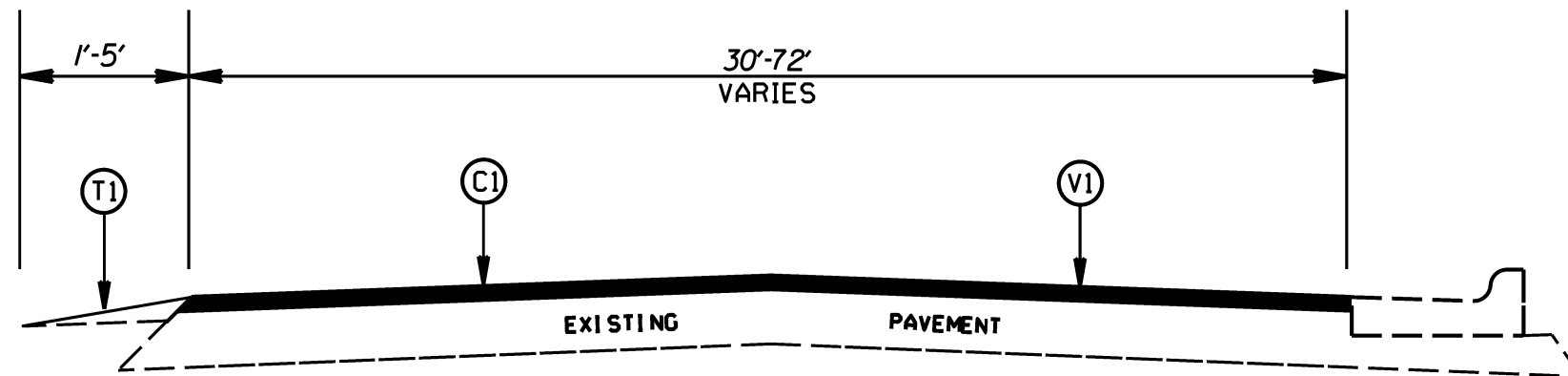

TYPICAL SECTION NO. 2

MAP 1 - NC 3 (BRANCHVIEW DRIVE NE)

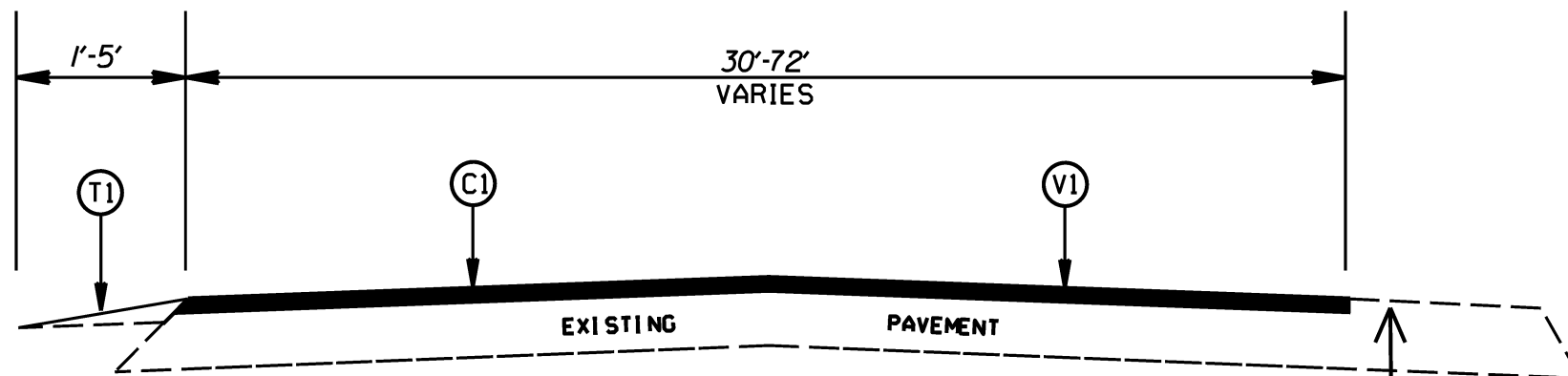

TYPICAL SECTION NO. 3

MAP 1 - NC 3 (BRANCHVIEW DRIVE NE)

PAVED / CONCRETE  
 ENTRANCES AT  
 VARIOUS LOCATIONS

STATE	PROJECT NO.	SHEET NO.	TOTAL SHEETS
N.C.	2023CPT.10.14.10131 2023CPT.10.14.20131	5	14
F.A. PROJECT NO.			

PAVEMENT SCHEDULE	
C1	PROP. APPROX. 1.50" ASPHALT CONCRETE SURFACE COURSE, TYPE S9.5C. AT AN AVERAGE RATE OF 168 LBS. PER SQ. YDS.
T1	SHOULDER RECONSTRUCTION
V1	MILLING OF EXISTING PAVEMENT, 1.50"

NOTES:  
 1. LEVELING COURSE TO BE PLACED AS DIRECTED BY THE ENGINEER

CABARRUS COUNTY  
 RESURFACING SPRING 2022

SCALE	-NA-		REVISIONS
DATE	10/21		
DESIGNED BY	JWH		
APPROVED	JWH		

STATE	PROJECT NO.	SHEET NO.	TOTAL SHEETS
N.C.	2023CPT.10.14.10131 2023CPT.10.14.20131	6	14
F.A. PROJECT NO.			

PAVEMENT SCHEDULE	
C1	PROP. APPROX. 1.50" ASPHALT CONCRETE SURFACE COURSE, TYPE S9.5C, AT AN AVERAGE RATE OF 168 LBS. PER SQ. YDS.
T1	SHOULDER RECONSTRUCTION
V1	MILLING OF EXISTING PAVEMENT, 1.50"

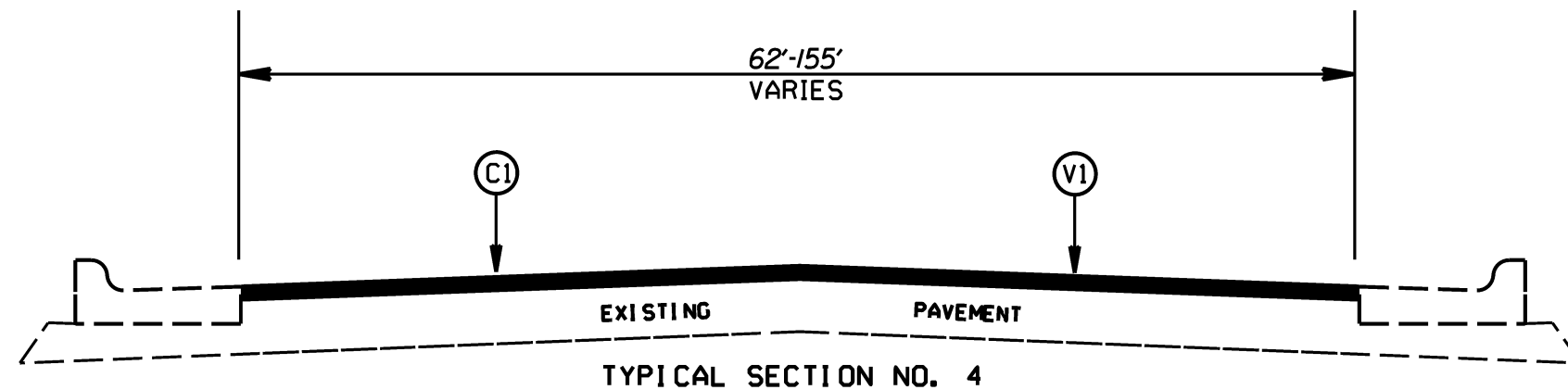

TYPICAL SECTION NO. 4

MAP 2 - SR 1430 (KANNAPOLIS PARKWAY)  
MAP 3 - SR 1430 (GEORGE W. LILES PARKWAY NW)

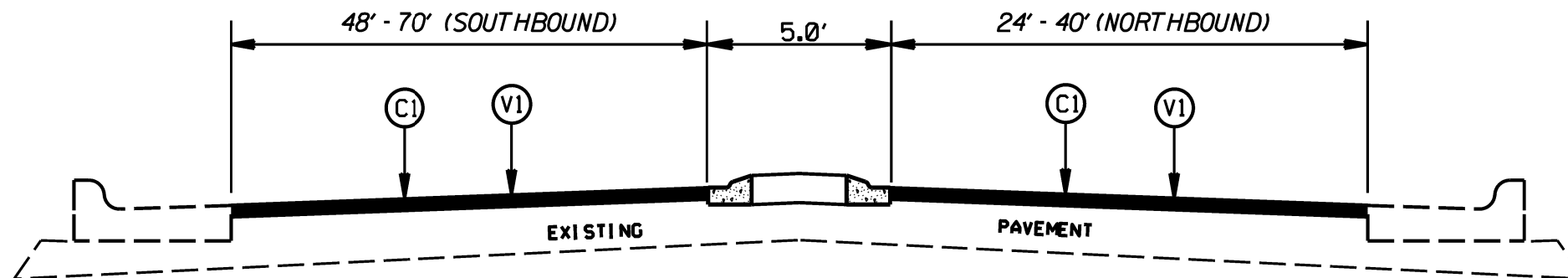

TYPICAL SECTION NO. 5

MAP 3 - SR 1430 (GEORGE W. LILES PARKWAY NW) (SOUTHBOUND)  
MAP 4 - SR 1430 (GEORGE W. LILES PARKWAY NW) (NORTHBOUND)

NOTES:  
1. LEVELING COURSE TO BE PLACED AS DIRECTED BY THE ENGINEER

CABARRUS COUNTY RESURFACING SPRING 2022		
SCALE	-NA-	
DATE	10/21	
DESIGNED BY	JWH	
APPROVED	JWH	
		REVISIONS

STATE	PROJECT NO.	SHEET NO.	TOTAL SHEETS
N.C.	2023CPT.10.14.10131 2023CPT.10.14.20131	7	14
F.A. PROJECT NO.			

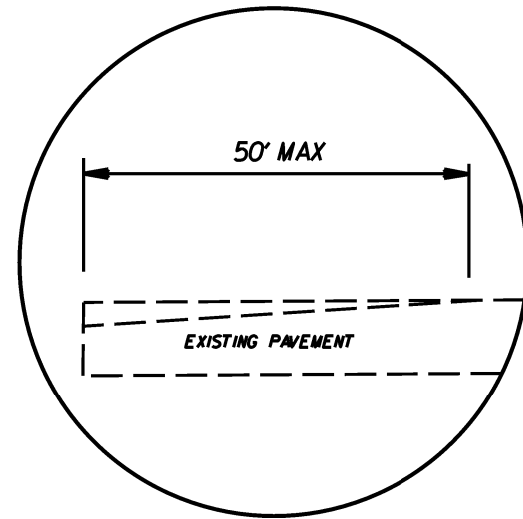

DETAIL FOR INCIDENTAL MILLING (0° TO 1.0°)  
TIE-IN

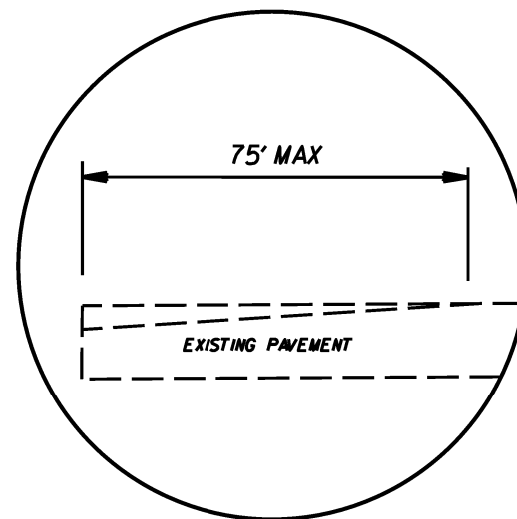

DETAIL FOR INCIDENTAL MILLING (0° TO 1.5°)  
TIE-IN

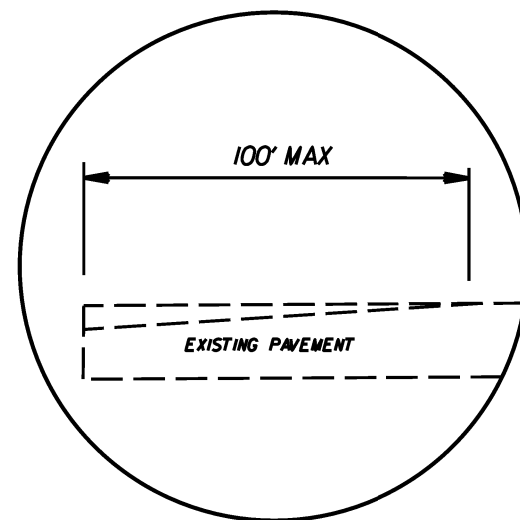
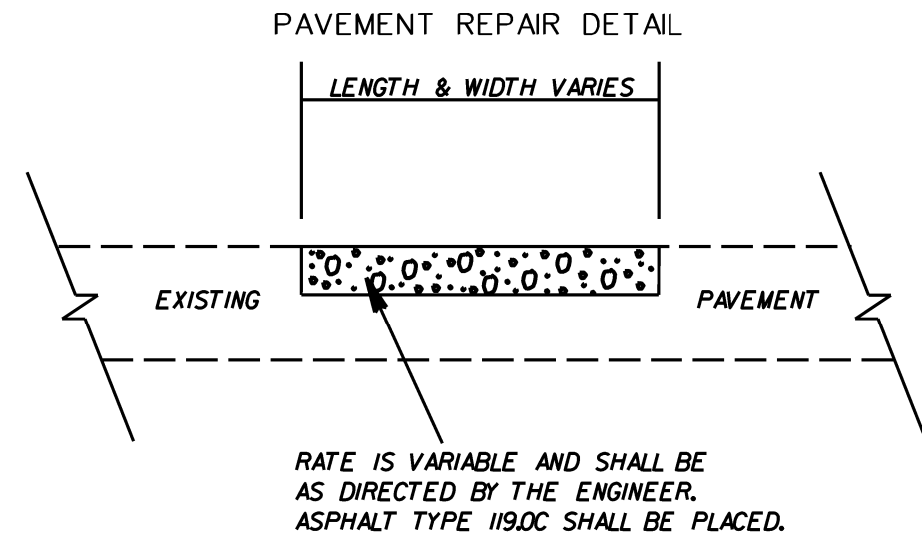

DETAIL FOR INCIDENTAL MILLING (0° TO 2.0°)  
TIE-IN

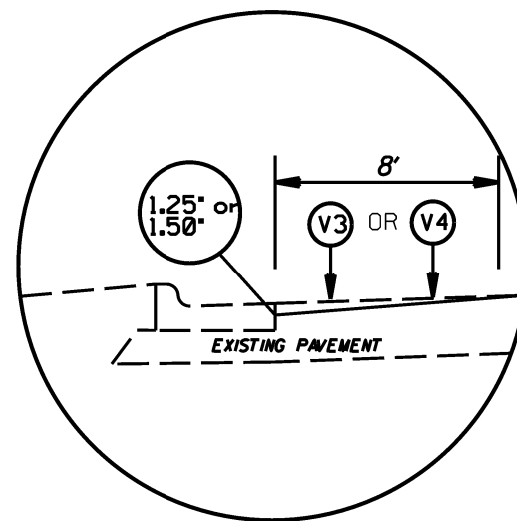

DETAIL FOR PROFILE MILLING (0° TO 1.25°) OR (0° TO 1.50°)

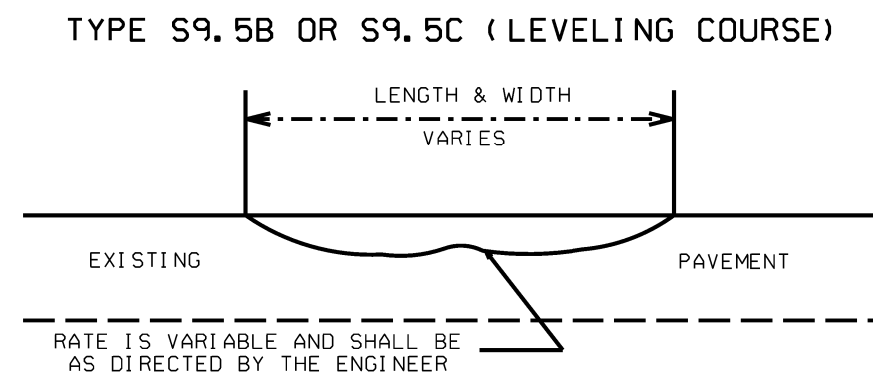

PATCHING, LEVELING, MILLING, PROFILE MILLING DETAILS		
SCALE	-NA-	REVISIONS
DATE	11/21	
DWG. BY	JAB	
DESIGN BY	JAB	
APPROVED	JAB	



NOTES:

- 1) DETAIL DOES NOT APPLY TO OGAFCC AND ULTRA-THIN BONDED WEARING COURSE.
- 2) BACKFILL SHOULDER WITH APPROVED MATERIAL.
- 3) THE SHOULDER WEDGE DEVICE MAY BE DISENGAGED AT PAVED DRIVEWAYS AND SIDE STREETS.

STATE	PROJECT NO.	SHEET NO.	TOTAL SHEETS
N.C.	2023CPT.10.14.10131 2023CPT.10.14.20131	8	14
F.A. PROJECT NO.			

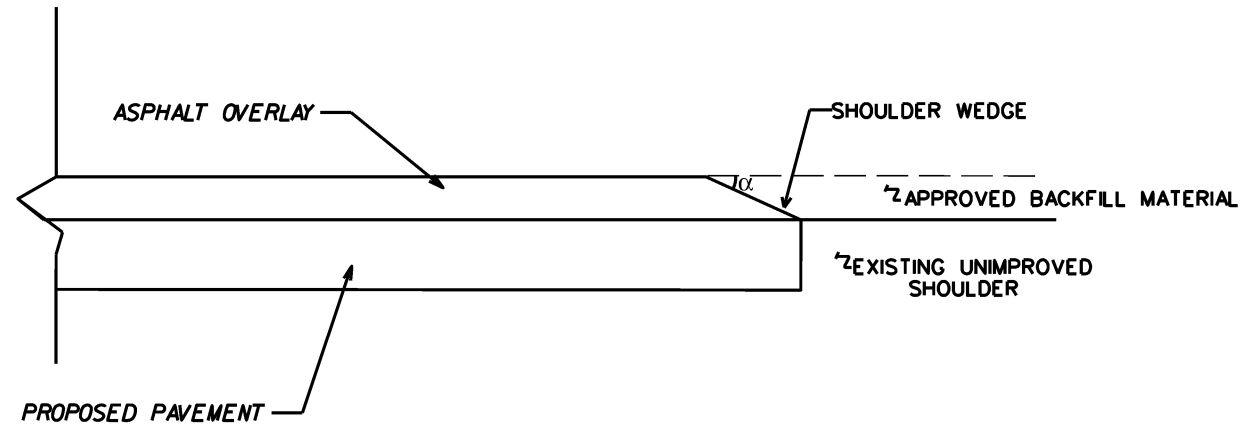

SHOULDER WEDGE DETAIL

(RESURFACING PROJECTS W/ WIDENING OR WITH EXISTING PAVED SHOULDER HAVING NO DROPOFFS)

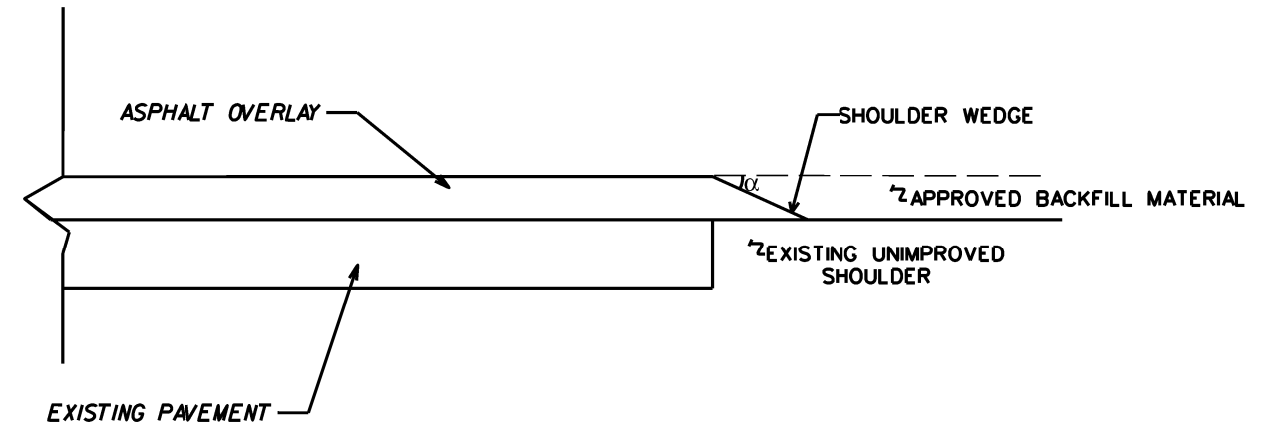

SHOULDER WEDGE DETAIL

(RESURFACING PROJECTS W/ NO WIDENING)

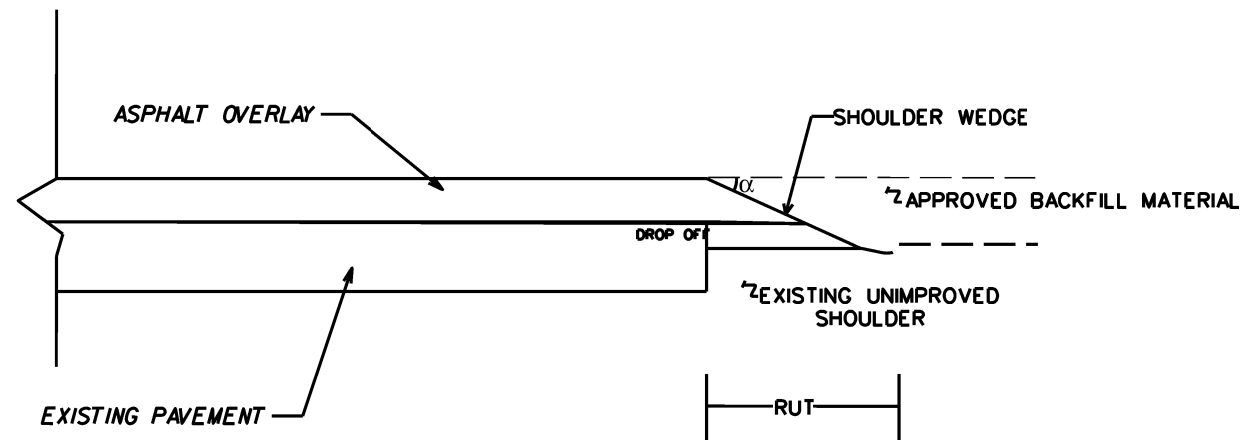

SHOULDER WEDGE DETAIL  
(RESURFACING ADJACENT TO RUTTED SHOULDER)

$\alpha = 30$  DEGREES

SHOULDER WEDGE DETAILS		
SCALE	-NA-	REVISIONS
DATE	2/18	
DWG. BY	JAB	
DESIGN BY	JAB	
APPROVED	JAB	





NOTES: LESS THAN 5' - 10' UNDISTURBED BUFFER FROM ROW, DITCHLINE, WATER FEATURE, OR DRAINAGE INLET, ADD BMP.

BMP OPTIONS: WATTLE OR SILT FENCE

STATE	PROJECT NO.	SHEET NO.	TOTAL SHEETS
N.C.	2023CPT.10.14.10131 2023CPT.10.14.20131	9	14
F.A. PROJECT NO.			

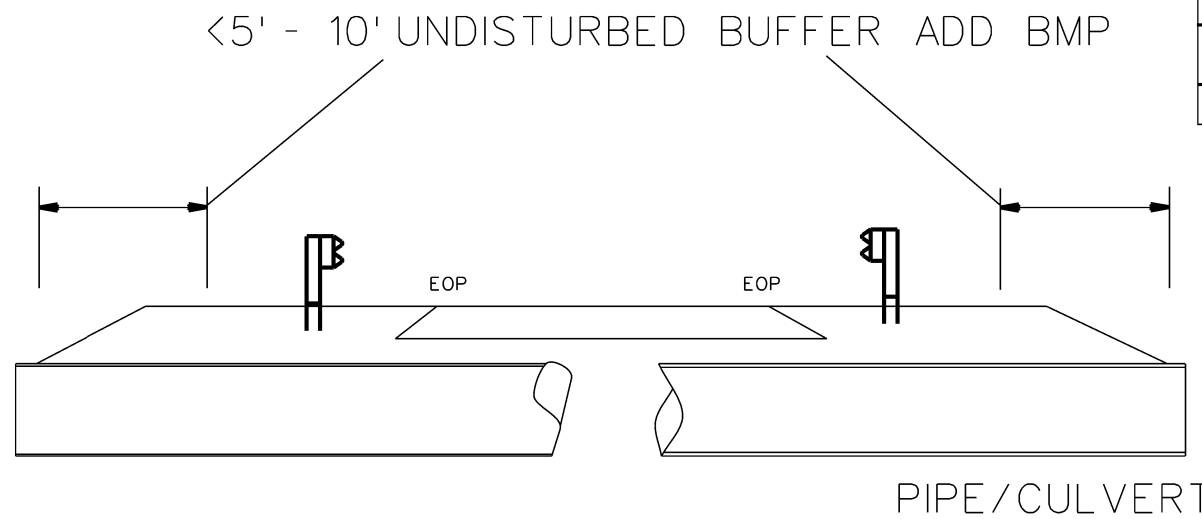

<5' - 10' UNDISTURBED BUFFER FROM JURISDICTIONAL FEATURE ADD BMP

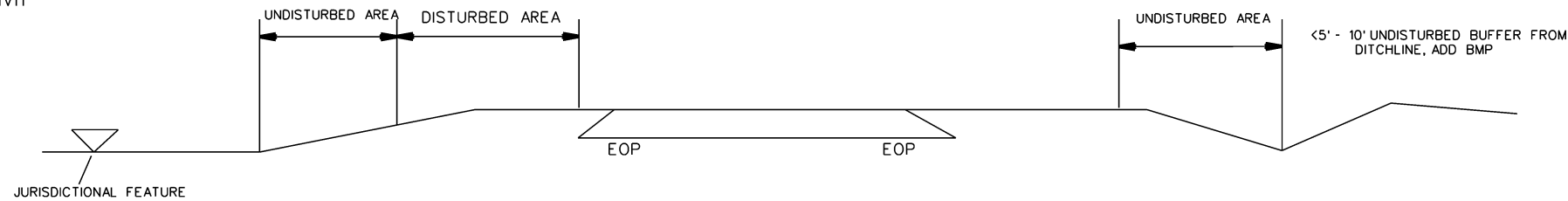

USE BMP'S IF SHOULDERS AND/OR FRONTSLOPES AND/OR DITCHLINE AND/OR BACKSLOPES ARE DISTURBED

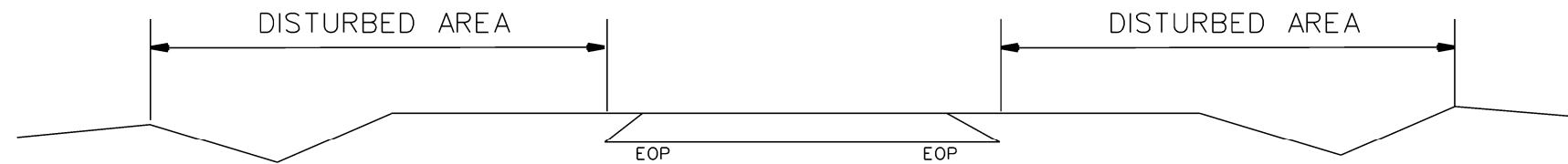

<5' - 10' UNDISTURBED BUFFER FROM INLET, ADD WATTLE

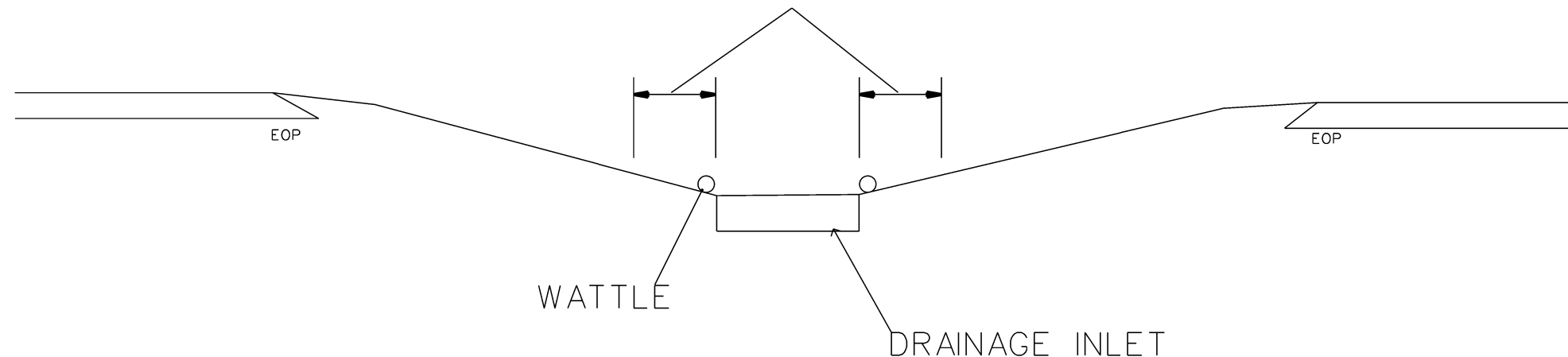

EROSION CONTROL DETAIL

SCALE	-NA-		REVISIONS
DATE	2/18		
DWG. BY	JAB		
DESIGN BY	JAB		
APPROVED	JAB		

# WATTLE WITH POLYACRYLAMIDE DETAIL

STATE	PROJECT NO.	SHEET NO.	TOTAL SHEETS
N.C.	2023CPT.10.14.10131 2023CPT.10.14.20131	10	14
F.A. PROJECT NO.			

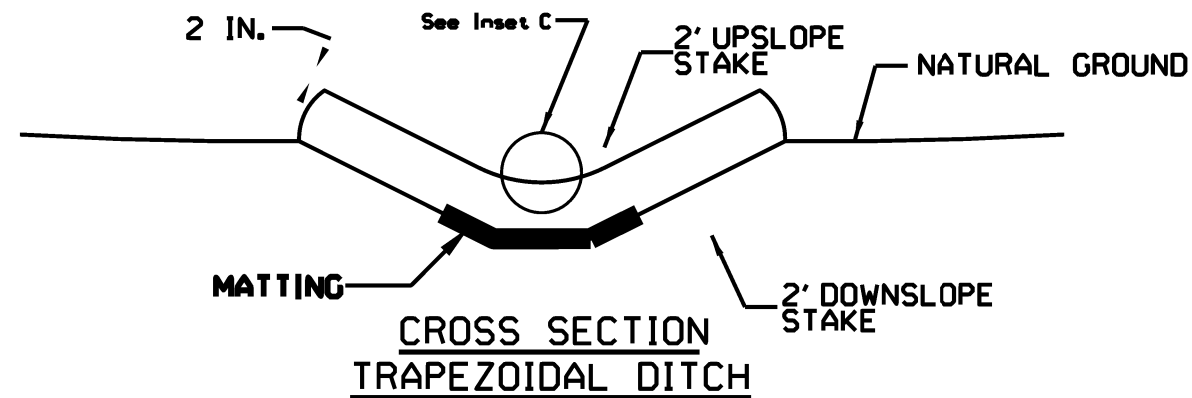
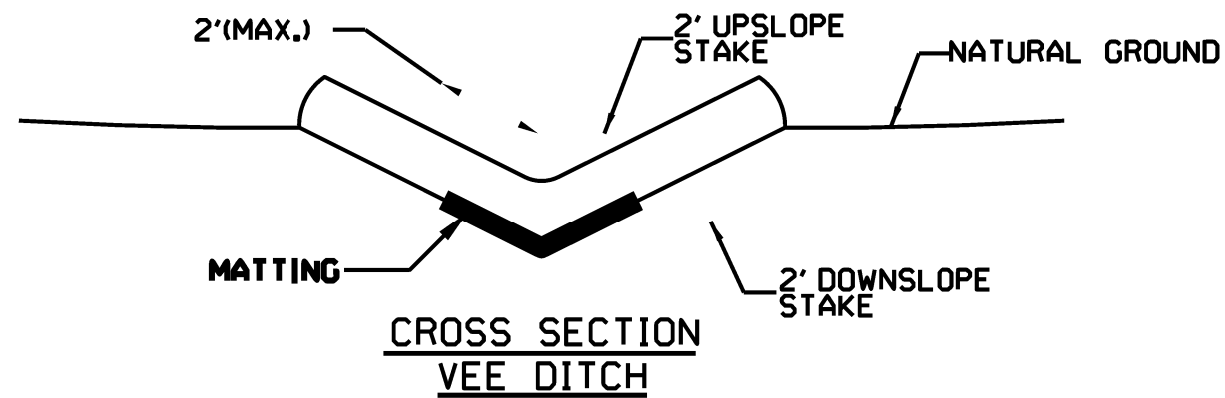
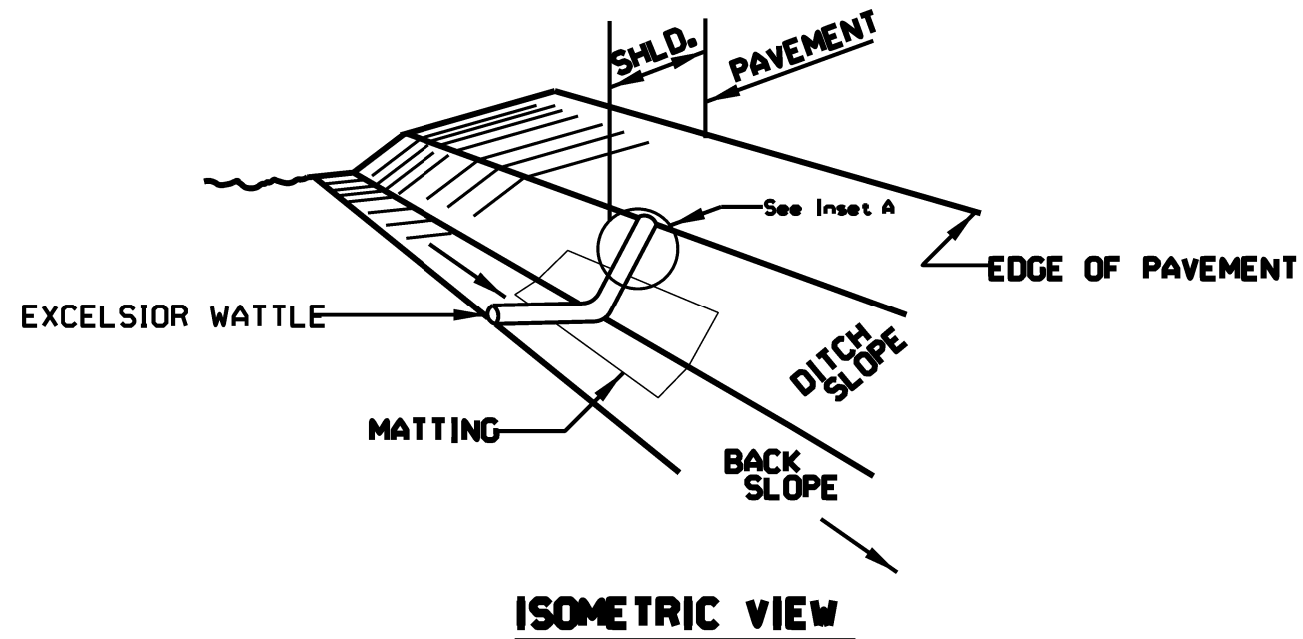

**NOTES:**

USE MINIMUM 12 IN. DIAMETER EXCELSIOR WATTLE.

USE 2 FT. WOODEN STAKES WITH A 2 IN. BY 2 IN. CROSS SECTION.

INSTALL A MINIMUM OF 2 UPSLOPE STAKES AND 4 DOWNSLOPE STAKES AT AN ANGLE TO WEDGE WATTLE TO BOTTOM OF DITCH.

PROVIDE STAPLES MADE OF 0.125 IN. DIAMETER STEEL WIRE FORMED INTO A U SHAPE NOT LESS THAN 12" IN LENGTH.

INSTALL STAPLES APPROXIMATELY EVERY 1 LINEAR FOOT ON BOTH SIDES OF WATTLE AND AT EACH END TO SECURE IT TO THE SOIL.

INSTALL MATTING IN ACCORDANCE WITH SECTION 1631 OF THE STANDARD SPECIFICATIONS.

PRIOR TO POLYACRYLAMIDE (PAM) APPLICATION, OBTAIN A SOIL SAMPLE FROM PROJECT LOCATION, AND FROM OFFSITE MATERIAL, AND ANALYZE FOR APPROPRIATE PAM FLOCCULANT TO BE APPLIED TO EACH WATTLE.

INITIALLY APPLY 3.5 OUNCES OF ANIONIC OR NEUTRALLY CHARGED POLYACRYLAMIDE (PAM) OVER WATTLE WHERE WATER WILL FLOW AND AFTER EVERY RAINFALL EVENT THAT IS EQUAL TO OR EXCEEDS 0.50 IN.

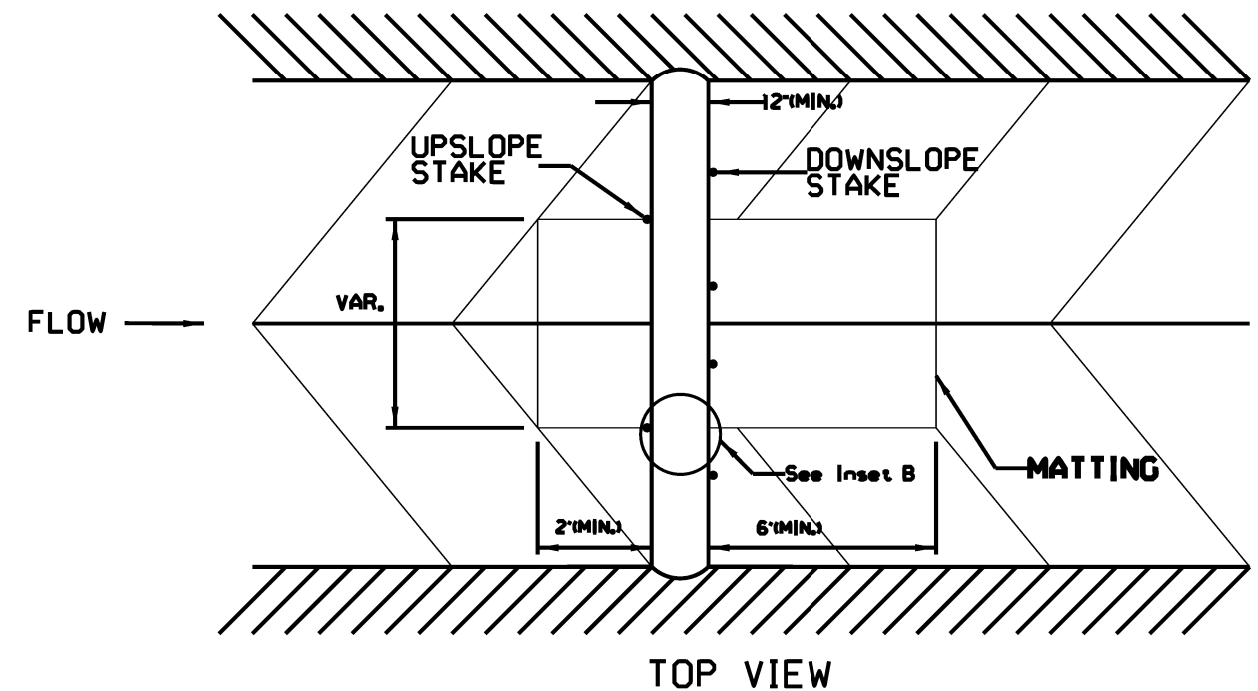
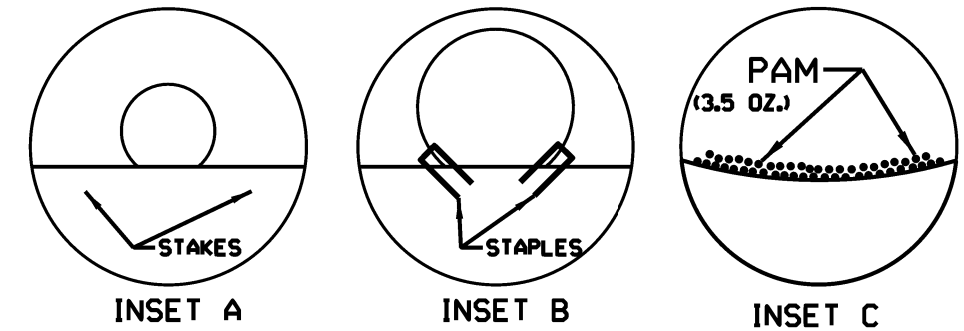

LEGEND	
	STATIONARY SIGN
	DIRECTION OF TRAFFIC FLOW

# SIGNING FOR RESURFACING PROJECTS

STATE	PROJECT NO.	SHEET NO.	TOTAL SHEETS
N.C.	2023CPT.10.14.10131 2023CPT.10.14.20131	11	14
F.A. PROJECT NO.			

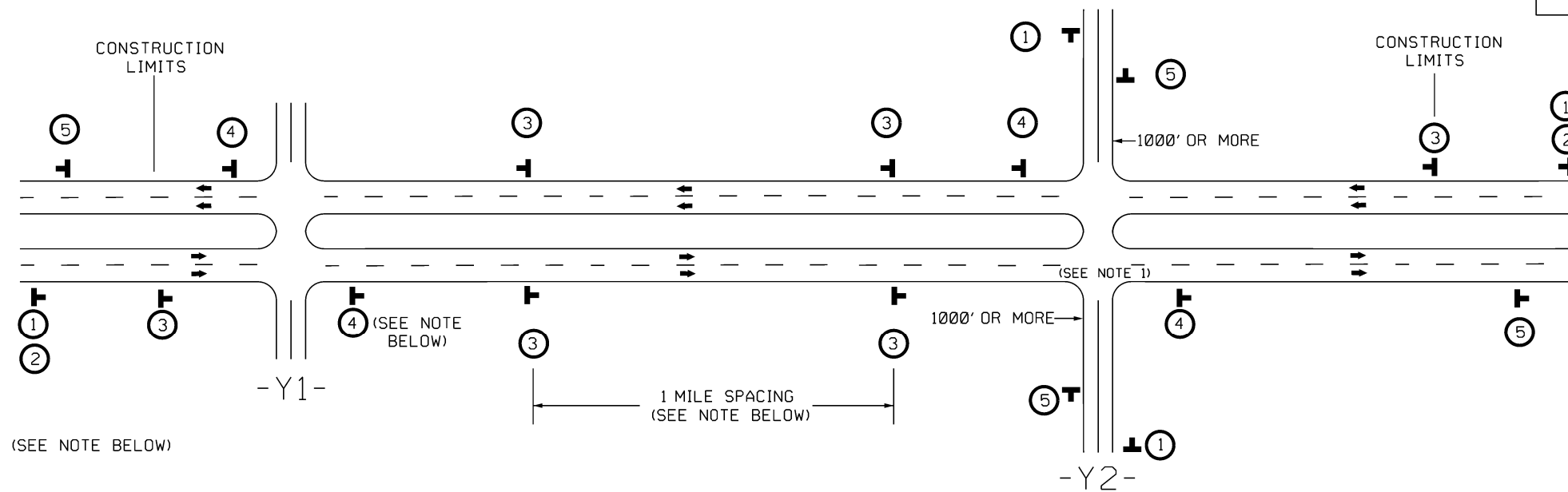

## MAINLINE (-L-) SIGNING

## -Y- LINE SIGNING

SIGNING NOTES AND PLACEMENT PER DIRECTION	<p>①  W20-1 48" X 48"</p> <p>②  W7-30P 24" X 18"</p> <p>PLACE 1000' PRIOR TO BEGINNING OF CONSTRUCTION LIMITS. ONLY USED ON -Y- LINES IF RESURFACING LIMITS EXTEND 1000' ALONG -Y- LINE.</p> <p>#2 SIGN ONLY USED WHEN CONSTRUCTION LIMITS ARE 2 OR MORE MILES IN LENGTH. ROUND UP TO NEXT WHOLE NUMBER. (NO FRACTIONAL OR DECIMAL NUMBERS)</p>	<p>NO REQUIRED STATIONARY SIGNING FOR THE FOLLOWING -Y- LINE CONDITIONS:</p> <ol style="list-style-type: none"> <li>LESS THAN 1000' OF RESURFACING ALONG -Y- LINE</li> <li>SUBDIVISION ROADS</li> <li>DEAD END ROADS</li> </ol> <p>WHEN PAVING/CONSTRUCTION ACTIVITIES PROCEED ACROSS AN UNSIGNED -Y- LINE, PORTABLE ADVANCE WARNING SIGNS SHALL BE USED ALONG THE -Y- LINE AS SHOWN BELOW. REMOVE UPON COMPLETION OF WORK.</p> <p> W20-1 48" X 48" PLACED 500' IN ADVANCE OF FLAGGER.</p> <p> W20-7 A 48" X 48" PLACED 250' IN ADVANCE OF FLAGGER.</p> <p>NOTES:</p> <ol style="list-style-type: none"> <li>MAY USE LAW ENFORCEMENT TO CONTROL TRAFFIC AT SIGNALIZED INTERSECTIONS AS DIRECTED BY THE ENGINEER. PROVIDE PORTABLE "ROAD WORK AHEAD" (W20-1) SIGNS 500' IN ADVANCE ALONG BOTH APPROACHES FROM THE SIDE STREETS WHEN PAVING PROCEEDS THROUGH THE INTERSECTION.</li> </ol>
	<p>③  SP 13107 48" X 48"</p> <p>PLACE INITIALLY AT THE CONSTRUCTION LIMITS AND SPACE 1 MILE APART THEREAFTER. IF NO -Y- LINES EXIST, PLACE 2ND SET 1/2 MILE FROM THE CONSTRUCTION LIMITS AND THEN SPACE 1 MILE APART THEREAFTER. (NOTE: THESE SIGNS ARE TO BE OMITTED IN CURB AND CUTTER SECTIONS)</p>	
	<p>④  SP 13106 48" X 48"</p> <p>THESE ARE FOR -Y- LINES THAT ARE "THROUGH" ROADWAYS. DEAD END AND SUBDIVISION ROADS ARE NOT "THROUGH" ROADWAYS. INSTALL 500' +/- FROM EACH -Y- LINE APPROACH AS SHOWN ABOVE. FOR MULTIPLE -Y- LINES THAT ARE SEPARATED BY 0.25 MILES OR LESS, TREAT AS A SINGLE UNIT AND INSTALL WITHIN 500' OF EACH APPROACH. A MAXIMUM OF 2 SIGN SETS PER MILE. DO NOT INSTALL WHEN -Y- LINES ARE WITHIN 0.5 MILES FROM "END ROAD WORK" SIGN.</p>	
	<p>⑤  G20-2 A 48" X 24"</p> <p>PLACE 500' FOLLOWING THE END OF CONSTRUCTION LIMITS</p>	

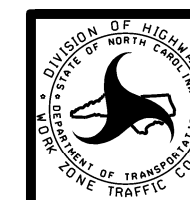

RESURFACING  
ADVANCE WARNING SIGNS  
FOR RURAL AND SUBURBAN  
MULTI-LANE ROADWAY  
W/ SHOULDER SECTIONS

# SIGNING FOR RESURFACING PROJECTS

STATE	PROJECT NO.	SHEET NO.	TOTAL SHEETS
N.C.	2023CPT.10.14.10131 2023CPT.10.14.20131	12	14
F.A. PROJECT NO.			

LEGEND	
⊣	STATIONARY SIGN
←	DIRECTION OF TRAFFIC FLOW

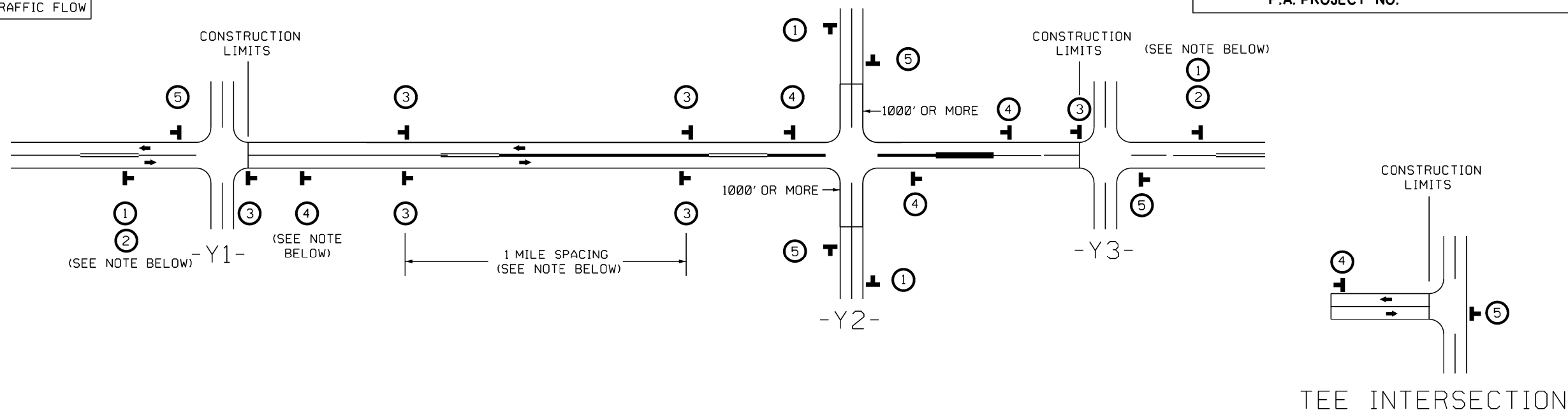

## MAINLINE (-L-) SIGNING

## -Y- LINE SIGNING

SIGNING NOTES AND PLACEMENT PER DIRECTION	1	ROAD WORK AHEAD	PLACE 1000' PRIOR TO BEGINNING OF CONSTRUCTION LIMITS. ONLY USED ON -Y- LINES IF RESURFACING LIMITS EXTEND 1000' ALONG -Y- LINE.	NO REQUIRED STATIONARY SIGNING FOR THE FOLLOWING -Y- LINE CONDITIONS:  1) LESS THAN 1000' OF RESURFACING ALONG -Y- LINE 2) SUBDIVISION ROADS 3) DEAD END ROADS  WHEN PAVING/CONSTRUCTION ACTIVITIES PROCEED ACROSS AN UNSIGNED -Y- LINE, PORTABLE ADVANCE WARNING SIGNS SHALL BE USED ALONG THE -Y- LINE AS SHOWN BELOW. REMOVE UPON COMPLETION OF WORK.
	2	NEXT XX MILES	*2 SIGN ONLY USED WHEN CONSTRUCTION LIMITS ARE 2 OR MORE MILES IN LENGTH, ROUND UP TO NEXT WHOLE NUMBER. (NO FRACTIONAL OR DECIMAL NUMBERS)	
	3	LOW/SOFT SHOULDER	- PLACE INITIALLY AT THE CONSTRUCTION LIMITS AND SPACE 1 MILE APART THEREAFTER. - AT TEE INTERSECTIONS INSTALL INITIALLY 1/2 MILE FROM INTERSECTION AND SPACE 1 MILE APART THEREAFTER.	
	4	ROAD UNDER CONST	- THESE ARE FOR -Y- LINES THAT ARE 'THROUGH' ROADWAYS. - DEAD END AND SUBDIVISION ROADS ARE NOT 'THROUGH' ROADWAYS. - INSTALL 500' +/- FROM EACH -Y- LINE APPROACH AS SHOWN ABOVE. - FOR MULTIPLE -Y- LINES THAT ARE SEPARATED BY 0.25 MILES OR LESS, TREAT AS A SINGLE UNIT AND INSTALL WITHIN 500' OF EACH APPROACH. - A MAXIMUM OF 2 SIGN SETS PER MILE. DO NOT INSTALL WHEN -Y- LINES ARE WITHIN 0.5 MILES FROM 'END ROAD WORK' SIGN. - FOR TEE INTERSECTIONS, INSTALL WITHIN 500' +/- OF THE INTERSECTION ALONG -L- LINE.	
	5	END ROAD WORK	PLACE 500' FOLLOWING THE END OF CONSTRUCTION LIMITS OR AS SHOWN WHEN WORK ENDS AT A 3-WAY TEE INTERSECTION.	

THE ABOVE SIGNS ARE ALL THAT ARE REQUIRED FOR A CONTRACTOR TO BEGIN A RESURFACING CONTRACT. ANY ADDITIONAL SIGNS REQUESTED BY NCDOT DIVISIONS SHALL BE INSTALLED WITHIN 7 BUSINESS DAYS OF THE START OF CONTRACT WORK.

MAPS LESS THAN 2 MILES

FOR RESURFACING MAPS WITH CONSTRUCTION LIMITS LESS THAN 2 MILES IN LENGTH, NO STATIONARY SIGNS ARE REQUIRED. USE PORTABLE 'ROAD UNDER CONSTRUCTION' OR 'ROAD WORK AHEAD' SIGNS IN LIEU OF STATIONARY ADVANCE WARNING SIGNS.

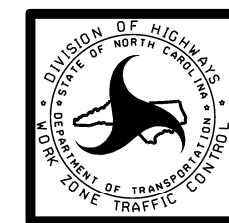

ADVANCE WARNING SIGNS FOR RURAL AND SUBURBAN 2-LANE ROADWAY RESURFACING

PROJECT NO.	SHEET NO.	TOTAL NO.
2023CPT.10.14.10131, 2023CPT.10.14.20131	13	14

### SUMMARY OF QUANTITIES

PROJECT NO	COUNTY	MAP NO	ROUTE	DESCRIPTION	TYP NO	LANES	LANE TYPE	FINAL SURFACE TESTING REQUIRED	WARM MIX ASPHALT REQUIRED	LENGTH		WIDTH	0106000000-E	1220000000-E	1245000000-E	1297000000-E	1330000000-E	1523000000-E	1575000000-E	1704000000-E	2600000000-N	2612000000-E	2830000000-N	2845000000-N	5255000000-N	6071010000-E	6071020000-E	7444000000-E
										BORROW	INCIDENTAL STONE BASE		SHOULDER RECONSTRUCTION	1½" MILLING	INCIDENTAL MILLING	SURFACE COURSE, \$9.5C	ASPHALT BINDER FOR PLANT MIX	PATCHING EXISTING PAVEMENT	RETROFIT EXISTING CURB RAMP	6" DRIVEWAYS	ADJ. OF MANHOLES	ADJ. OF METER OR VALVE BOX	PORTABLE LIGHTING	WATTLE	POLYACRYLAMIDE (PAM)	INDUCTIVE LOOP		
										MI	FT	CY	TONS	SMI	SY	SY	TONS	TONS	TONS	EA	SY	EA	EA	LS	LF	LB	LF	
2023CPT.10.14.10131	Cabarrus	1	30000003013 - NC 3 (BRANCHVIEW DRIVE NE)	FROM NC 73 (CORBAN AVENUE SE) (MP 2.90) TO BROOKWOOD AVENUE NE (MP 4.57)	1,2,3	2		NO	NO	1.67	32		205	15	2.98	31,419	12,406	4,100	270	500	1.00	36	5	10	0.45	200	1	3,179
<b>TOTAL FOR MAP NO. 1</b>										1.67		205	15	2.98	31,419	12,406	4,100	270	500	1.00	36	5	10	0.45	200	1	3,179	
<b>TOTAL FOR PROJ NO. 2023CPT.10.14.10131</b>										1.67		205	15	2.98	31,419	12,406	4,100	270	500	1.00	36	5	10	0.45	200	1	3,179	
2023CPT.10.14.20131	Cabarrus	2	40001430013 - SR 1430 - KANNAPOLIS PARKWAY	FROM NC 73 (MP 4.16) TO EXCHANGE STREET (MP 5.74)	1,4	2		NO	NO	1.58	60		15		0.22	63,966	7,574	6,625	424	550			10	8	0.43			2,584
<b>TOTAL FOR MAP NO. 2</b>										1.58		15		0.22	63,966	7,574	6,625	424	550			10	8	0.43			2,584	
2023CPT.10.14.20131	Cabarrus	3	40001430013 - SR 1430 - GEORGE LILES PARKWAY NW	FROM EXCHANGE STREET (MP 5.74) TO SR 1394 (POPLAR TENT ROAD) (MP 6.08)	4,5	2		NO	NO	0.34	75					11,594	2,021	1,300	84	120	5.00		4	1	0.09			1,203
<b>TOTAL FOR MAP NO. 3</b>										0.34					11,594	2,021	1,300	84	120	5.00		4	1	0.09			1,203	
2023CPT.10.14.20131	Cabarrus	4	4040143013 - SR 1430 - GEORGE LILES PARKWAY NW	FROM SR 1394 (POPLAR TENT ROAD) (MP 4.06) TO END CONCRETE ISLAND (MP 4.18)	5	2		NO	NO	0.12	26					2,100	240	240	16	42			1	1	0.03			
<b>TOTAL FOR MAP NO. 4</b>										0.12					2,100	240	240	16	42			1	1	0.03				
<b>TOTAL FOR PROJ NO. 2023CPT.10.14.20131</b>										2.04		15		0.22	77,660	9,835	8,165	524	712	5.00		15	10	0.55			3,787	
<b>GRAND TOTAL</b>										3.71		220	15	3.20	109,079	22,241	12,265	794	1,212	6.00	36	20	20	1.00	200	1	6,966	

PROJECT NO.	SHEET NO.	TOTAL NO.
2023CPT.10.14.10131, 2023CPT.10.14.20131	14	14

**THERMOPLASTIC AND PAINT QUANTITIES**

PROJECT NO	COUNTY	MAP NO	ROUTE	DESCRIPTION	TYP NO	LANES	LANE TYPE	LENGTH	WIDTH	4413000000-E	4457000000-N	4510000000-N	4685000000-E		4695000000-E		4709000000-E	4720000000-E	4725000000-E		4770000000-E		4810000000-E		4835000000-E	4905100000-N			
										WORK ZONE ADVANCE/GENERAL WARNING SIGNING	TEMPORARY TRAFFIC CONTROL	LAW ENFORCEMENT	4" X 90 M WHITE THERMO	4" X 90 M YELLOW THERMO	8" X 90 M YELLOW THERMO	8" X 90 M WHITE THERMO	THERMOPLASTIC PAVEMENT MARKING LINES (24", 90 MILS)	THERMO MSG ONLY 90 M	THERMO LT ARROW 90 M	THERMO RT ARROW 90 M	THERMO STR ARROW 90 M	THERMO STR & RT ARROW 90 M	THERMO STR & LT ARROW 90 M	COLD APPLIED PLASTIC PAVEMENT MARKING LINES, TYPE II (4" WHITE)	COLD APPLIED PLASTIC PAVEMENT MARKING LINES, TYPE II (4" YELLOW)	4" YELLOW PAINT	4" WHITE PAINT	24" WHITE PAINT	NON-CAST IRON SNOWPLOWABLE PAVEMENT MARKER
								MI	FT	SF	LS	HR	LF	LF	LF	LF	EA	EA	EA	EA	EA	EA	LF	LF	LF	LF	LF	EA	
2023CPT.10.14.10131	Cabarrus	1	30000003013 - NC 3 (BRANCHVIEW DRIVE NE)	FROM NC 73 (CORBAN AVENUE SE) (MP 2.90) TO BROOKWOOD AVENUE NE (MP 4.57)	1,2,3	2		1.67	32	190.0	0.45	120	21,600	21,300	425		460	8	21	11	4	5			15,000	5,000	400	280	
<b>TOTAL FOR MAP NO. 1</b>								1.67		190.0	0.45	120	21,600	21,300	425		460	8	21	11	4	5			15,000	5,000	400	280	
<b>TOTAL FOR PROJ NO. 2023CPT.10.14.10131</b>								1.67		190.0	0.45	120	21,600	21,300	425		460	8	21	11	4	5			15,000	5,000	400	280	
													<b>42,900</b>		<b>425</b>				<b>41</b>				<b>20,000</b>						
2023CPT.10.14.20131	Cabarrus	2	40001430013 - SR 1430 - KANNAPOLIS PARKWAY	FROM NC 73 (MP 4.16) TO EXCHANGE STREET (MP 5.74)	1,4	2		1.58	60	180.0	0.43	160	10,750	20,100	464	1,265	800	24	59	21	43		2	800.00	500.00	12,600	6,000	800	642
<b>TOTAL FOR MAP NO. 2</b>								1.58		180.0	0.43	160	10,750	20,100	464	1,265	800	24	59	21	43		2	800	500	12,600	6,000	800	642
2023CPT.10.14.20131	Cabarrus	3	40001430013 - SR 1430 - GEORGE LILES PARKWAY NW	FROM EXCHANGE STREET (MP 5.74) TO SR 1394 (POPLAR TENT ROAD) (MP 6.08)	4,5	2		0.34	75	48.0	0.09	80	2,425	3,260	26		200		15	7	8	1			3,000	2,200		91	
<b>TOTAL FOR MAP NO. 3</b>								0.34		48.0	0.09	80	2,425	3,260	26		200		15	7	8	1			3,000	2,200		91	
2023CPT.10.14.20131	Cabarrus	4	4040143013 - SR 1430 - GEORGE LILES PARKWAY NW	FROM SR 1394 (POPLAR TENT ROAD) (MP 4.06) TO END CONCRETE ISLAND (MP 4.18)	5	2		0.12	26	24.0	0.03	40	340	590			30		2							340		12	
<b>TOTAL FOR MAP NO. 4</b>								0.12		24.0	0.03	40	340	590			30		2							340		12	
<b>TOTAL FOR PROJ NO. 2023CPT.10.14.20131</b>								2.04		252.0	0.55	280	13,515	23,950	490	1,265	1,030	24	76	28	51	1	2	800	500.00	15,600	8,540	800	745
													<b>37,465</b>		<b>1,755</b>				<b>158</b>				<b>1,300</b>		<b>24,140</b>				
<b>GRAND TOTAL</b>								3.71		442.0	1.00	400	35,115	45,250	915	1,265	1,490	32	97	39	55	6	2	800	500.00	30,600	13,540	1,200	1,025
													<b>80,365</b>		<b>2,180</b>				<b>199</b>				<b>1,300.00</b>		<b>44,140</b>				